

Tiny Home

the Darrell

 Chalet Series

1 Bedroom

 1 Bath

 390 Square Feet

 12 x 33

starting at

\$74,488

 includes delivery



In Stock: as shown **\$79,900**

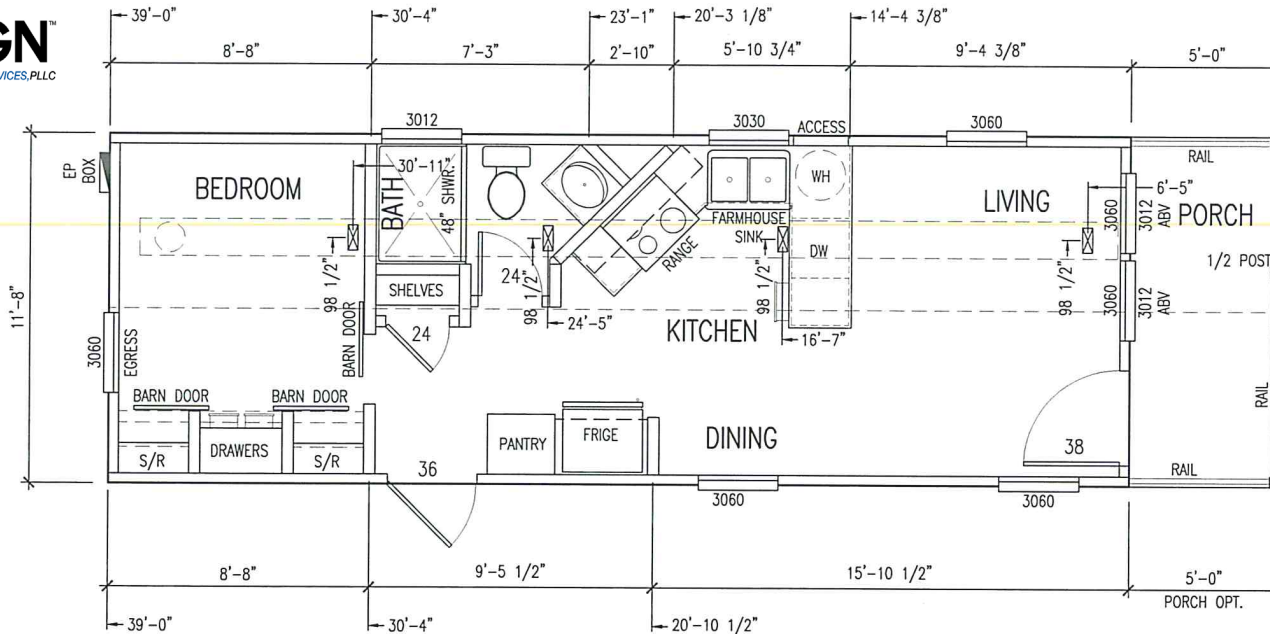

Included Chalet Package

- 6 ft porch
- 9' side walls
- Transom windows
- Residential fascia
- Tape and texture walls t/o
- Flat ceilings with top trim
- Upgraded window and door casings
- Tile backsplash
- Lap siding with OSB wrap
- Residential outswing door
- Garbage disposal
- Interior panel doors
- LED can lights



Need Financing?

 Scan for 21st Mortgage

 application

Standard Features

CONSTRUCTION:

- 2'x6' Engineered Joist
- 2'x4' Interior Walls (Insulated)
- 8' or 9' Foot Sidewalls
- 5/8" OSB Tongue & Groove Floors T/O
- High Gage Vinyl Flooring T/O
- Knockdown Flat Ceilings
- Interior Wall Insulation in Bedrooms
- Rolled Edge Formica Countertops
- Vinyl Covered Sheetrock T/O
- 1" 1/2 Vinyl Wrapped Flat Luan Trim
- Insulation: R-11 Walls R-11 Floors R-22 Ceiling

EXTERIOR:

- 5/12 Roof Pitch
- Frame, Roofing, Siding and Windows
- Detachable Hitch
- 3 on 12 Gable Pitch w/ 6" vented eave
- 7/16 OSB Roof Decking
- 55 Year Smart Panel Siding
- Engineered Trusses
- 2 x 4 Exterior Walls
- Grade 2 Privacy Knob Set
- Access for Water Heaters
- Vinyl Low E Thermal Pane Windows
- House Wrap Under Exterior Siding
- Flashing Tape Windows and Doors
- 5000 LB Brake and Idler Axles

INTERIOR:

- Flat Ceilings
- 6 Panel Interior Doors
- 2" Blinds (White)
- Privacy Door Locks in Bath & MBR
- Wire Shelving in Closets

Baths:

- Brushed Nickel Faucets
- Light Bar Vanity
- 24 x 36 Mirror
- Porcelain Lavatory
- Fiberglass Shower and Tubs
- Elongated Toilet
- 50 CFM Exhaust Fans

Kitchen:

- 42 in. Cabinets
- Black Appliances: Coil Top Range, Microwave, Dishwasher, Refrigerator
- Double Bowl Stainless Steel Sink

Electrical:

- 20 Amp Weatherproof Ext. GFI Recep
- GFI in Bath and Kitchen Countertops
- 15 Amp 125V Single Pole Switch
- Smoke Det with Battery Backup
- 40 Amp Disconnect Box
- 20 Gallon Water Heater
- 100 Amp Interior Panel Box
- PTAC Units x2